

Pull-Only Brake

1500 & 3000 Control Cable Assembly

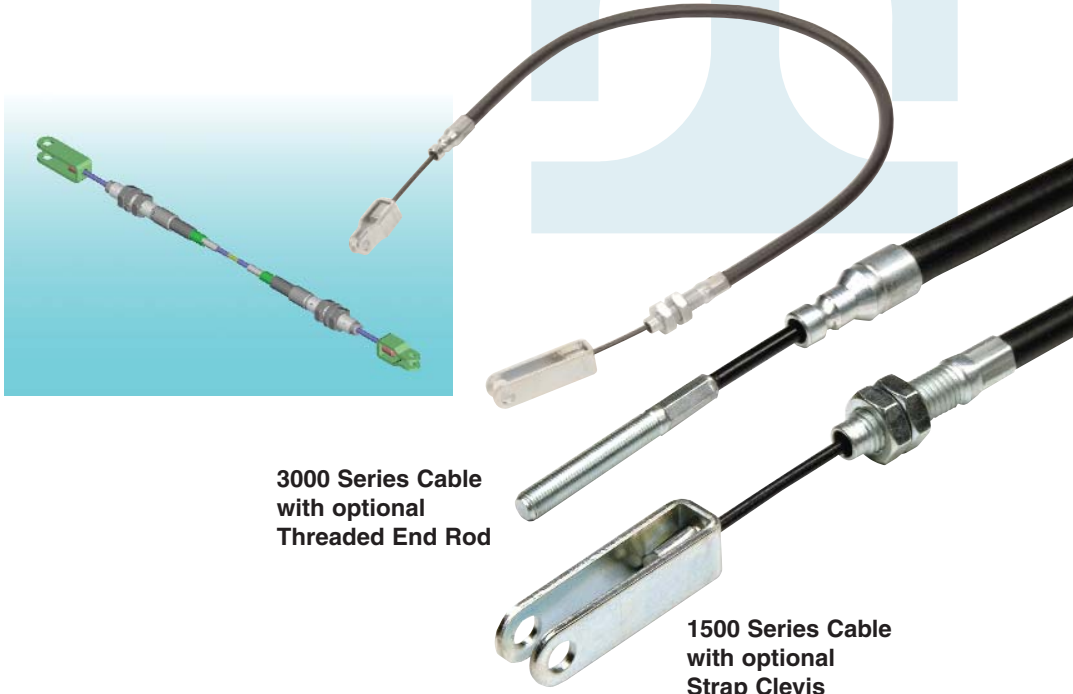

**3000 Series Cable
with optional
Threaded End Rod**

**1500 Series Cable
with optional
Strap Clevis**

Pull-Only Industrial

A flexible control designed to transmit pull motion between two mechanical devices without the use of rods, bellcranks, or other rigid mechanical linkage. Pull controls are specifically designed for applications which require a high load capability and low deflection. The cable often used for operating a vehicle parking brake is a typical example. Simple to install and easy to maintain, our versatile pull controls are found on many types of mechanical equipment.



Description:

1500 Pull-Only Brake
3000 Pull-Only Brake
Industrial Control
Cable Assembly

Applications:

- Park brakes
- Pull-pull cable systems

Features:

- High load capacity
1500 allows up to
1500lb loads
- Low deflection
3000 allows up to
3000lb loads
- Installed bend radius
down to 5"

Other Related Products:

- Hand Control Brake
- Clutch

Pull-Only Brake

1500lb Series

Ultimate Load: 1500lb
Minimum Bend Radius: 5"

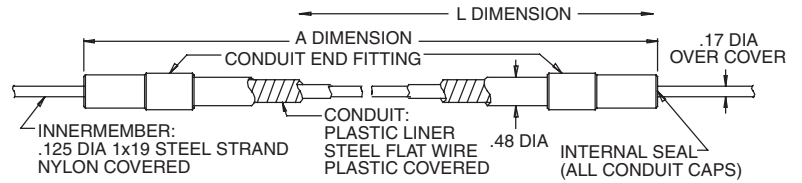

Grooved End Fittings

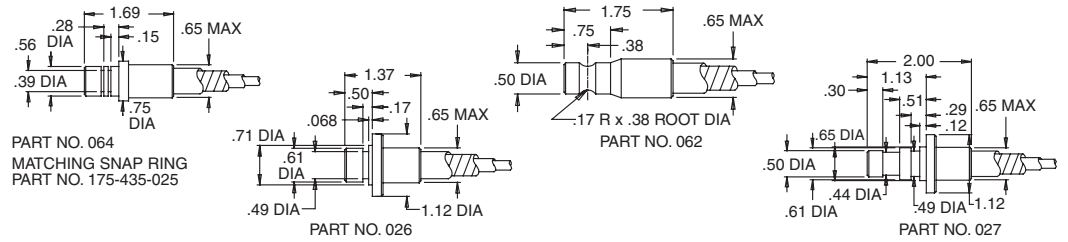

Threaded End Fittings

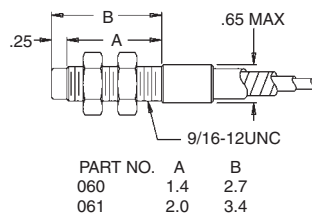

48° Clip-Lock End Fitting

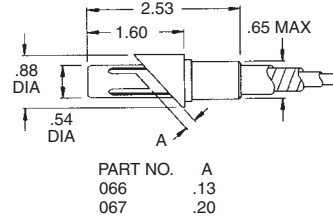

Clip-Lock End Fitting

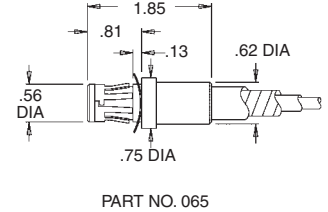

Ball End

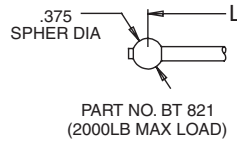

Eye End

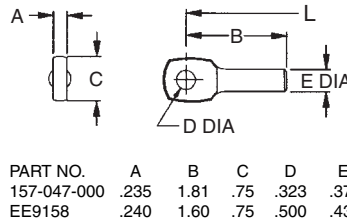

Cable Stop

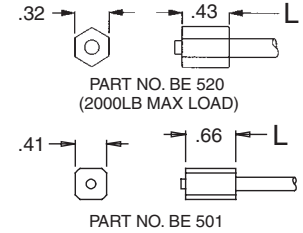

3000lb Series

Ultimate Load: 3000lb
Minimum Bend Radius: 7"

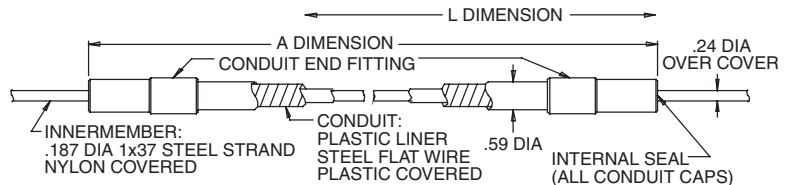

Grooved End Fittings

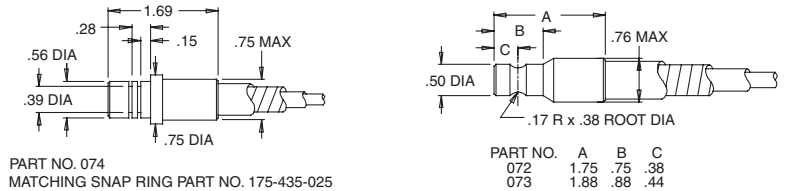

Threaded End Fittings

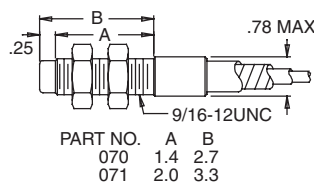

48° Clip-Lock End Fitting

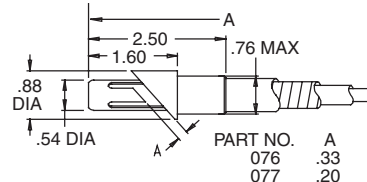

Clip-Lock End Fitting

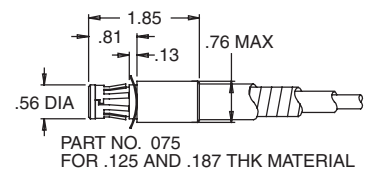

Ball End

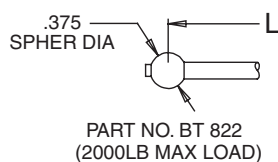

Eye End

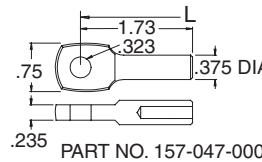

Cable Stop

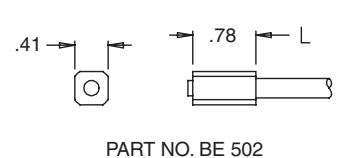

Pull-Only Brake Specifications

1500 Brake

Threaded End Fitting	A	B	C
TE504	5/16-24	3.70	2.22
TE504-006	5/16-24	2.08	.97
TE504-007	5/16-24	6.08	4.60
TE506	3/8-24	2.74	1.47
TE523-001	1/4-28	3.68	2.47

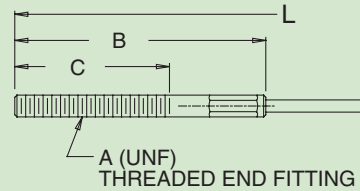

3000 Brake

Threaded End Fitting	A	B	C
TE505	3/8-24	2.95	2.00
TE505-1	3/8-24	1.88	1.00
TE508	3/8-24	2.62	1.50
TE509-1	3/8-24	4.95	3.75
TE510-1	5/16-24	2.50	1.50
TE510-2	5/16-24	3.62	2.24
TE510-4	5/16-24	4.00	3.00
TE510-5	1/4-28	3.62	2.50
TE510-6	5/16-24	2.12	1.00
TE510-7	5/16-24	2.88	1.50
TE510-8	5/16-24	5.60	4.47
TE510-9	5/16-24	3.00	1.91
TE605	3/8-24	6.00	5.00

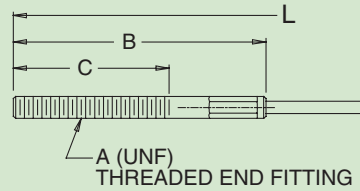

Strap Clevis Part Numbers (For both 1500 and 3000 brake)

Open Strap Clevis	A	B	D	F	G	H
CS540	-	1.62	.31	.62	.43	.266
CS540-1	-	1.62	.31	.62	.51	.266
CS540-6	-	2.50	.38	.75	.57	.386
CS540-7	-	2.50	.31	.62	.51	.266
CS541	-	1.94	.38	.75	.51	.266
CS541-3	-	1.94	.38	.75	.51	.323
CS541-5	-	2.00	.38	.75	.51	.266
CS541-7	-	2.50	.38	.75	.51	.266
CS541-8	-	2.50	.38	.75	.51	.323
CS542*	-	1.08	.50	1.00	.58	.323

Step Strap Clevis	A	B	C	D	F	H
CS550	.31	1.56	.19	.31	.62	.266
CS550-1	.31	1.56	.19	.38	.62	.266
CS550-2	.31	1.56	.19	.31	.62	.316
CS550-4	.31	1.56	.19	.25	.62	.266
CS551	.38	1.75	.25	.31	.62	.266
CS551-1	.38	1.75	.25	.38	.62	.266
CS551-2	.75	2.38	.25	.31	.62	.316
CS551-3	.38	1.50	.25	.25	.62	.266
CS552	.31	2.38	.25	.31	.75	.266
CS552-1	.31	2.38	.25	.38	.75	.266
CS552-3	.38	2.38	.25	.43	.75	.316
CS552-4	.38	2.38	.25	.31	.75	.316
CS553	.50	1.88	.19	.38	.75	.266

Closed Strap Clevis	A	B	C	D	F	H
CS562	.31	1.62	-	.31	.62	.316
CS563	.28	1.75	-	.31	.62	.316
CS564	1.00	2.38	-	.38	.75	.316

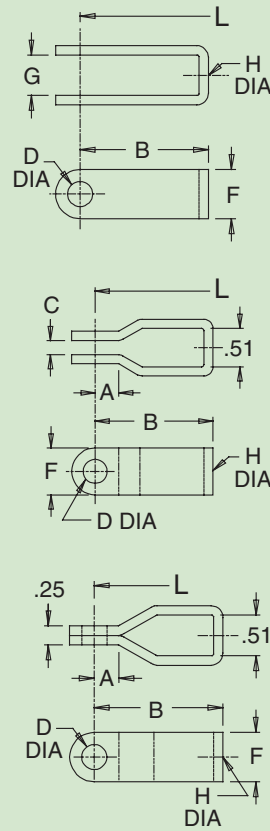

*use with 5/16 threaded end rod with nuts only

All line art dimensions are represented in inches

Pull-Only Brake Order Code

Material

- Carbon Steel and Plastic

Suggested End Fittings

- All 1500 & 3000lb Brake Cable Fittings
- Rod Ends
- Clevises

Industrial Push-Only Brake

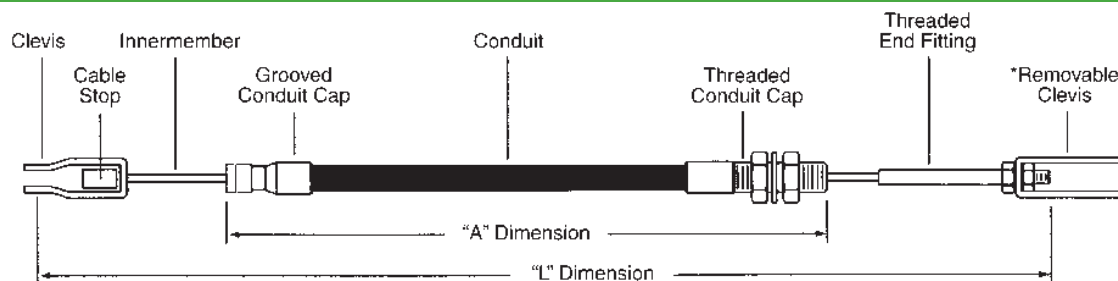

To specify a pull-only brake, the following information must be given in the order listed:

1. Left innermember end fitting part number.
 2. Left conduit end fitting part number.
 3. Length "A" between conduit fitting reference points in inches.
 4. Right conduit end fitting part number.
 5. Right innermember end fitting part number.
 6. Length "L" of innermember assembly between fitting reference points in inches.
 7. Travel of the innermember in the conduit in inches. (Note: dimensions "L" must be sufficiently greater than dimension "A" to allow desired travel).
- *Removable items should be listed separately.

Cablecraft® Ordering Codes

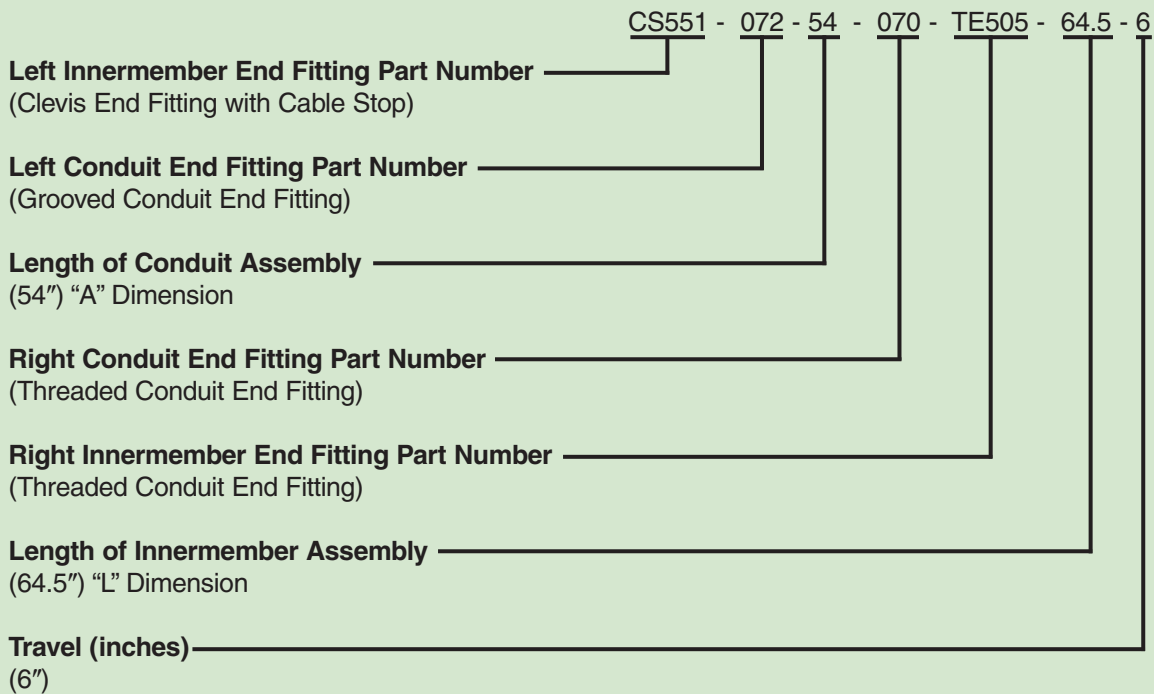

• Please refer to the cautions/warnings and appropriate installation usage information in the Technical/Application Data sheet
 • For application assistance/technical questions, please contact us at the appropriate location listed below or through our website at www.tuthillcontrols.com



TUTHILL
Controls Group

4401 South Orchard Street
Tacoma, Washington 98466 USA
Tel 253 475-1080 Fax 253 474-1623

2110 Summit Street
New Haven, Indiana USA 46774
Tel 260 749-5105 Fax 260 493-2387
www.tuthillcontrols.com

Diplocks Way-South Road
Hailsham, East Sussex BN27 3JF, England
Tel 44 1323 841510 Fax 44 1323 845848

Hingbergstrasse 79
45468 Mulheim an Der Rhur, Germany
Tel 49-208-300-650 Fax 49-208-300-6550

Linking Motion
& Control...
The Tuthill
Solution

